

STOCK AVAILABLE EX MELBOURNE WAREHOUSE AS AT 1ST OCTOBER 2008
 FOR CURRENT PRICING CONTACT AIRPORT METALS SALES DEPARTMENT ON ABOVE NUMBERS

ALUMINIUM SQUARE BAR

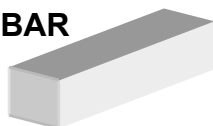

Type - Temper	Dimensions Inches
2024-T351	0.500 SQ
2024-T351	0.750 SQ
2024-T351	1.000 SQ
2024-T351	1.250 SQ
6061-T651	0.500 SQ
6061-T651	1.000 SQ
6061-T651	1.250 SQ
6061-T651	1.500 SQ
7075-T6511	1.000 SQ

ALUMINIUM RECTANGULAR BAR

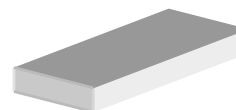

Type - Temper	Dimensions Inches
2024-T351	0.375 X 1.00
2024-T351	0.500 X 2.00
2024-T351	0.750 X 6.00
2024-T351	1.000 X 2.00
2024-T351	1.250 X 3.00
2024-T4	0.375 X 1.00
6061-T651	0.125 x 1.50
6061-T651	0.250 x 1.50
6061-T651	0.250 X 2.00
7075-T651	0.750 X 3.00
7075-T6511	1.000 X 2.50
7075-T651	1.500 X 5.00
7075-T651	2.000 X 2.50
7075-T7351	2.000 X 2.50

CHROME MOLY RECTANGULAR BAR

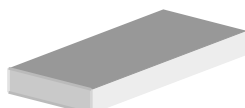

Specification	Dimensions Inches
4130N MIL-S-6758	.500 X 1.000
4130D4 MIL-S-6758	1.000 X 2.000
4130D4 MIL-S-6758	1.500 X 1.500

ALLOY STEEL HEX BAR



Specification	Dimensions Inches
BSS80D Cres Bright	0.625 AF

ALUMINIUM HEX BAR

Type - Temper	Dimensions Inches
2024-T351	1.125 AF
2024-T351	1.250 AF